

mahindra *Rise*

mahindra
Heavy Duty UH
Rotavator



Mahindra Heavy Duty UH Rotavator is specially designed for high performance in heavy soils under both dry and wet soil conditions. Its lightweight and robust design makes it a complete solution for progressive farmers tilling needs.

Features and Benefits

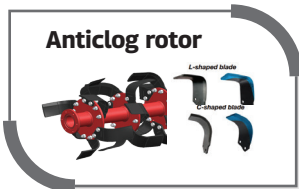

The helix spiral blade configuration rotor can accommodate 2 types of blades, C-shaped and L-shaped, designed for ultimate soil finishing and working crop residue into the ground. Blades are arranged helically around the rotor, resulting in the blades entering the soil progressively and thus reducing power draw. Also helps achieve finer tilth of soil. Specially designed for high performance in light and medium soils in both dry and wet soil conditions such as puddling.

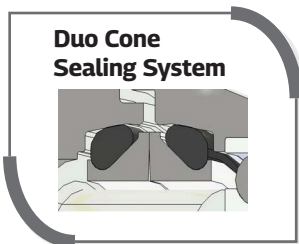

The Duo-Cone sealing system guarantees reliability without the need for maintenance. You can achieve at least 50% longer life from the Duo-Cone system than standard sealing systems in the most demanding working environments. The sealing system is completely waterproof or “amphibious” allowing the rotor and bearing to run in its own oil supply, this allows the rotor to work and be reliable in the dustiest of environments or even work immersed in water and yet the seals will still prevent water and dust ingress into the rotor and hubs.



A rather attractive optional extra is the anti-clogging system: a sheet metal membrane that stops clinging/wet soil from clogging up the machine.

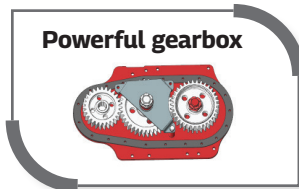

HD Tiller also features a 3-gear powertrain assembly at the side, which ensures constant transmission with no loss of power. The side transmission has been designed in such a way that load surges acting due to tangential forces acting on the stub axle shall get distributed on 3 pin topology over the side plates.

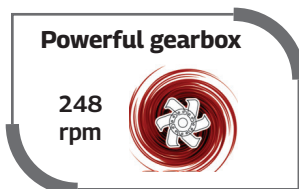

To achieve a finer tilth, an extra-powerful gearbox having (11X19) spiral gears are fitted, reaching 248 rpm.



Spiral bevel deployment in the gearbox that drives for high torque and high-speed operations. Since being the topology in right angle shaft orientation, also helps in drastic noise reduction. Smooth operation keeps the gear drive cool. Thus, minimising the need for repairs & maintenance.

Strong Levelling bonnets



The new strong levelling bonnets provide greater wear resistance while working on stony ground. Their Z shape means perfect soil levelling can be achieved in all conditions. They feature spring rods for adjusting the height with hand-holding unique brackets. Gearbox vibration can further be reduced by opting right combination of turn buckles, unique in the segment.

Stable Hitch Pyramid

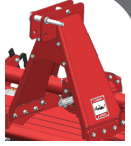

Working on stony & hard soil ground, the new strong box-type hitch pyramid structure provides greater strength. The front and rear plate keeps the hitch pyramid stable and increases strength.

Strong & dust free transmission covers

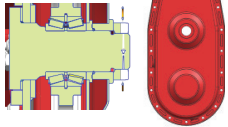

UM tiller models feature a transmission cover made from CR sheets, which is much stronger than regular grey cast iron. The cover has a chamfer on the inside housing that pushes in the O-ring inside, providing a much more effective seal to protect gears from dust and water ingress.

TECHNICAL SPECIFICATIONS

Parameters		Medium Duty 5'	Medium Duty 6'
Gearbox Type	SS / MS	SS	SS
Gearbox Bevel Pair	Pinion / Module	11 & 9	11 & 9
	Crown / Module	19 & 9	19 & 9
Gearbox Spur Set (Available)	For Bangladesh	-----	-----
	For Domestic	Not Applicable	Not Applicable
Side Gear Train	Top Gear / Module	27 / 6	27 / 6
	Idler Gear / Module	38 / 6	38 / 6
	Bottom Gear / Module	34 / 6	34 / 6
Centre Distance (Total) - (mm)		411 (Str. Config.)	411 (Str. Config.)
Distance (Tran. Housing axis to frame sheet)		119	119
Drive end side bearing configuration		Bearing 6309	Bearing 6309
Dead end side bearing configuration		Bearing 6209	Bearing 6209
Idler bearing configuration		Bearing 32008	Bearing 32008
Idler pin support type	Simply supported / Cantilever	Simply supported	Simply supported

Parameters		Medium Duty 5'	Medium Duty 6'
Drive end side plate thickness (mm)		8	8
Dead end side plate thickness (mm)		8	8
Main frame sheet thickness (mm)		5	5
Main Frame Front Pipe		60*60*6	60*60*6
Frame Stacking Plates thickness (mm)		8	8
Trailing board sheet thickness (mm)		2.5	2.5
Blade type construction	C Type / L Type	C & L Type Both (Available)	C & L Type Both (Available)
Rotor shaft configuration	Outward orientation / Inward orientation	Outwards Orientation	Outwards Orientation
Rotor swing Diameter (mm)		487 (L Type)	487 (L Type)
Rotor tube configuration		89 X 75	89 X 75
Rotor shaft speed (rpm)		248	248
Overall Dimensions (mm)		2080*1130*885	2305*1130*885
Tilling width (mm)		1910	2134
Recommended Tractor hp / kW range		45-60 / 34- 45	50-65 / 37- 49
Number of flanges on rotor shaft		8	9
Rotor Flange Diameter		265	265
Rotor Flange Thickness		12	12
Number of blades on rotor shaft		48	54
Number of blades per flange		6 Blades	6 Blades
Blade Overlapping (mm)		20	20
PTO input speed		540	540
Transmission type		Gear	Gear
Gap b/w frame sheet and rotor hull		44	44
Interchangeability of L & C Blade on same rotor		Yes	Yes
Frame construction type		Anti-clogging Type	Anti-clogging Type
Trailing board construction type		Z Type	Z Type
Three point linkage type		CAT I & QUICK HITCH	CAT I & QUICK HITCH
Weight (kg)		290 (Approx.)	315 (Approx.)
Sealing Type (Stub axle arrangements)	Multilip seal / Duo cone mechanical face seal	Duo-Cone Seal	uo-Cone Seal
Hitch Plate Thickness (mm)		6	6
Maximum Depth (cm)		18	18

Dealer's / Distributor's stamp

Address

Mahindra & Mahindra Ltd. Farm Equipment Sector, Farm Division AFS Headquarters, Mahindra Tower, 1st Floor, Akurli Road, Kandivali (E), Mumbai-400101, India